

SPECIFICATIONS

- 1-1/2" or 2" FPT connections standard (polypropylene bushings included).
- 4-1/4" gasketed top access port with captive hand-thread hardware.
- Liquid capacity: 2.1 Gallons (1-1/2"); 2 Gallons (2").
- Unit weight: 6 lbs. (dry); 23 lbs. (wet); 36 lbs. (wet w/ limestone).
- Maximum operating temperature 140°F continuous.

NOTES

- Top inlet and side inlet options standard.
- Built-in sewer gas trap.
- Bottom of tank must be supported if not sitting on floor. Support must hold at least 36 lbs. Bottom of tank designed to accommodate 4" plastic pipe (by others) as a support option.
- Uses: Neutralization (w/ limestone) or dilution (no limestone).

ENGINEER SPECIFICATION GUIDE

Striem neutralization tank model LB-2 shall be lifetime guaranteed and made in the USA. Tank shall be constructed of polyethylene. Tank shall be manufactured for above-grade installation. Tank shall be furnished with (2) inlets and (1) outlet connection with bushings included to field-adapt to 1-1/2" or 2" drain line pipe size. Tank shall be water-tight up to 36" head and contain an internal sewer gas trap. Tank shall have gasketed cover with captive hand-thread hardware.

INCLUDED

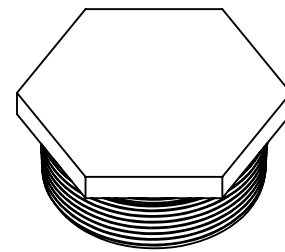

2" MPT Plug

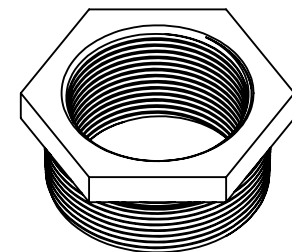

2" x 1-1/2" MPT Reducer (2)

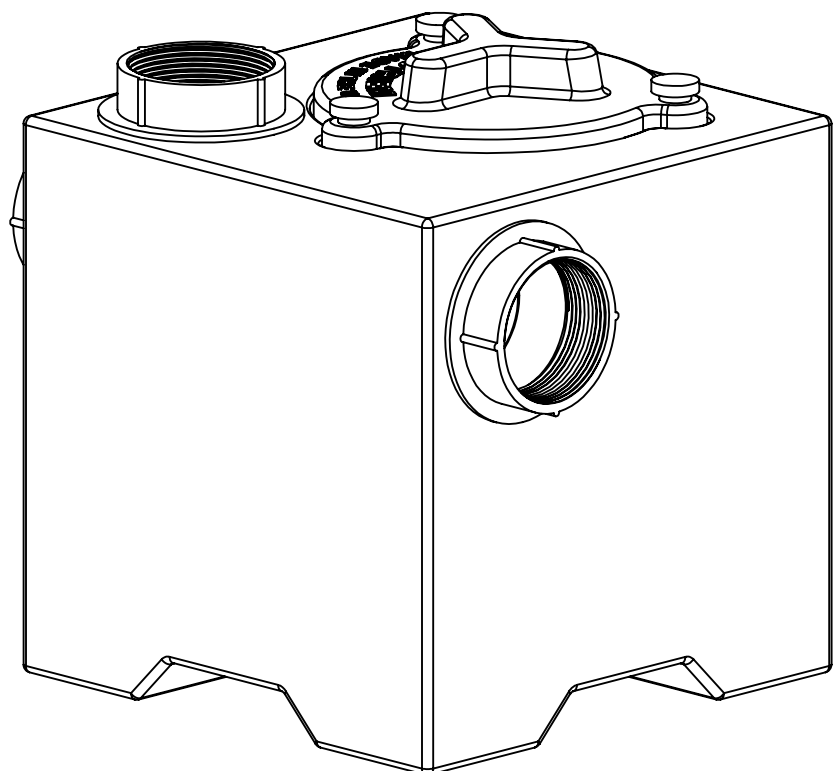

PROPRIETARY AND CONFIDENTIAL
 THE INFORMATION CONTAINED IN THIS DRAWING IS THE SOLE PROPERTY OF STRIEM, LLC.
 ANY REPRODUCTION IN PART OR AS A WHOLE WITHOUT THE WRITTEN PERMISSION OF STRIEM, LLC. IS PROHIBITED.

OPTIONS

Limestone: 90%+ Calcium Carbonate (25 lbs.)

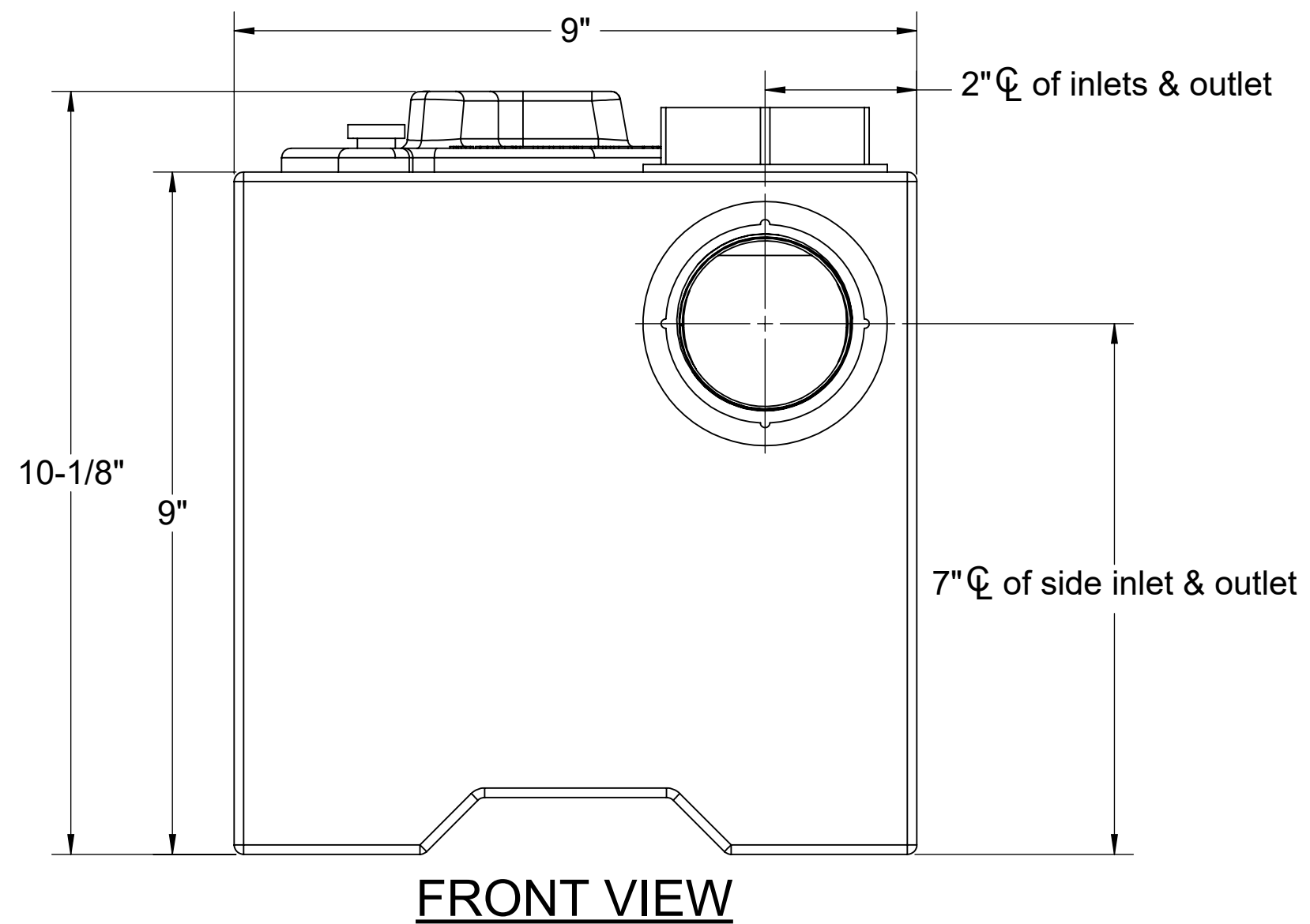
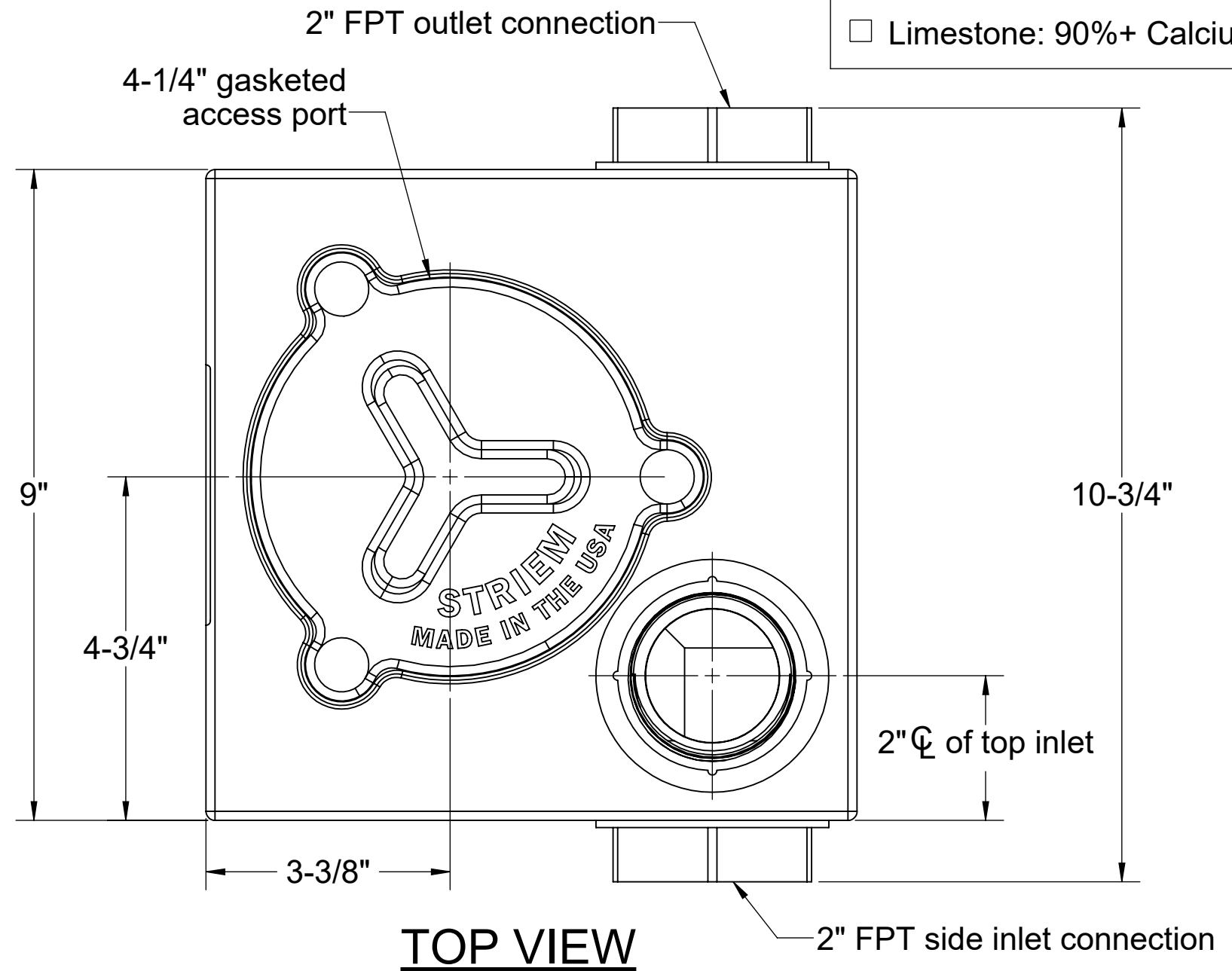

MODEL NUMBER:	LB-2
DESCRIPTION:	LAB RAT™ POLYETHYLENE POINT OF USE NEUTRALIZATION TANK
DWG BY:	ENG
DATE:	5/16/2023
REV:	0

SPECIFICATION SHEET

Striem
 Kansas City, KS
 Tel: 913-222-1500
 orders@striemco.com
 www.striemco.com

Made in the U.S.A

